



2010

Reproductive Health

Education • Research • Advocacy



Welcome to Reproductive Health 2010

September 22–25, 2010 • Hyatt Regency Atlanta • Atlanta, GA



Association of
Reproductive
Health
Professionals



SOCIETY of
FAMILY PLANNING

Dear friends and colleagues:

Welcome to Atlanta and thank you for attending *Reproductive Health 2010*. The Association of Reproductive Health Professionals (ARHP) is proud to partner with Planned Parenthood® Federation of America, Inc. (PPFA) and the Society of Family Planning (SFP) for the sixth consecutive year. Our goal is to bring together clinicians, researchers, students, and activists to facilitate translating the latest reproductive health research into practice.

If you have a question or need assistance, staff members from each partner organization are here to help. You can find us at the registration desk and in attendance at every conference event, wearing a name badge with a blue "staff" ribbon.

Thank you for participating in *Reproductive Health 2010* and for being a part of this dedicated community of reproductive health professionals.

To a great meeting-

Wayne C. Shields
President and CEO, ARHP

Vanessa Cullins, MD, MPH, MBA
Vice President for Medical Affairs, PPFA

Susan Higginbotham, MEd
Executive Director, SFP

WELCOME

Ultrasound in the Provision of First Trimester Abortion

At the conclusion of this educational session, participants should be able to:

- Be familiar with basic principles of pelvic sonography
- Understand ultrasonographic correlations in normal and abnormal early embryonic development, including ectopic pregnancy
- Have a clear understanding of the uses and limitations of sonography in the provision of first trimester abortions
- Have a clear understanding of uses and limitations of ultrasound in post medical abortion management

The Role of CNMs, NPs, and PAs in Unintended Pregnancy Prevention:

Professional and Clinical Competencies

At the conclusion of this educational session, participants should be able to:

- Identify the role of primary care clinicians in prevention and clinical management of unintended pregnancy
- Articulate three essential clinical and professional competencies for advancing practice for abortion provision by primary care clinicians
- Identify three successful strategies for attaining clinical and professional competency and knowledge of practice regulations necessary for the provision of abortion
- Demonstrate familiarity with the basic clinical competencies of early aspiration abortion and medication abortion
- Identify resources for professional and personal support for advancing scope of practice into the prevention and clinical management of unintended pregnancy

Vasectomy: The No-Scalpel Technique and Occlusion Methods

At the conclusion of this educational session, participants should be able to:

- Compare the efficacy, safety, and cost of vasectomy to tubal ligation
- List the basic steps in the no-scalpel vasectomy technique
- List the common occlusion methods in vasectomy
- Discuss common complications of vasectomy
- Appropriately counsel patients on vasectomy

LEARNING OUTCOMES

At the conclusion of *Reproductive Health 2010*, participants should be able to:

- Demonstrate newly acquired knowledge, attitudes, and skills when diagnosing and treating men, women, and adolescents for reproductive health conditions
- Integrate and translate evidence-based reproductive health and family planning into their own clinical setting, including lessons learned from scientific research in the United States and abroad
- Demonstrate effective communication and counseling skills about reproductive health with their patients and patients' families
- Incorporate an awareness of current social, political, and legal issues affecting reproductive health care into their professional practice
- Recognize and describe why the application of scientific research is crucial to the development of best practices in evidence-based medicine
- Describe the important role that scientific research plays in reproductive health and its impact on their current and future clinical practice

CONCURRENT, ACCREDITED PRE-CONFERENCE SESSIONS

How Will I Get My Continuing Education (CE) Credits for *Reproductive Health 2010*?

A more efficient and eco-friendly process is now in place for electronically gathering conference evaluations, facilitating participants' claiming of CE credits, and distributing certificates.



To Receive Your CE Certificate for the General Conference:

- Immediately following the meeting, check your e-mail for a message from the conference staff.
- Click on the link provided and complete the conference evaluation.
- At the end of the evaluation, click on the link directing you to claim your CE credits. Participants should only claim credit commensurate with the extent of their participation in the activity. You must claim the actual number of credits in order to receive CE credit and a certificate.
- Your CE certificate will be delivered via e-mail within 4 weeks of the meeting.

To Receive Your CE Certificate for a Pre-conference Session:

- At the conclusion of your pre-conference session, complete the evaluation and claim your credits.
- Your pre-conference CE certificate will be delivered via e-mail within 4 weeks of the pre-conference.

Nurse–Midwives

AMA PRA Category 1 Credits™ are accepted by the Continuing Competency Assessment Program of the American College of Nurse–Midwives for programs relevant to nurse–midwifery.

Nurse Practitioners

This educational activity will be approved by the Continuing Education Approval Program of the National Association of Nurse Practitioners in Women's Health (NPWH). It is estimated that NPWH will designate 20.25 contact hours for the general conference, including 11 pharmacology hours and 3.5 contact hours for each pre-conference session, including 1 pharmacology hour.

Pharmacists

The Association of Reproductive Health Professionals is accredited by the Accreditation Council for Pharmacy Education as a provider of continuing pharmacy education.

**Pre-conference Sessions**

This program provides 3.5 (.35 CEUs) contact hours of continuing pharmacy education credit as recognized by the Accreditation Council for Pharmacy Education. The assigned universal program number for *Reproductive Health (RH) 2010* pre-conference: Ultrasound in the Provision of First Trimester Abortion is 0463-0000-10-005-L04-P; The Role of CNMs, NPs and PAs in Unintended Pregnancy Prevention: Professional and Clinical Competencies is 0463-0000-10-006-L04-P; Vasectomy: The No-Scalpel Technique and Occlusion Methods is 0463-0000-10-007-L04-P. Each pharmacist must complete the post-test to receive credit for this activity.

General Conference

This program provides 20.25 (2.025 CEUs) contact hours of continuing pharmacy education credit as recognized by the Accreditation Council

for Pharmacy Education. The assigned universal program number is 0463-0000-10-008-L04-P. Each pharmacist must complete the post-test to receive credit for this activity.

Physician Assistants

The American Academy of Physician Assistants accepts AMA PRA Category 1 Credits™ toward AAPA continuing medical education (CME) credit.

Physicians

The Association of Reproductive Health Professionals is accredited by the Accreditation Council for Continuing Medical Education to provide continuing medical education for physicians.

Pre-conference Sessions

The Association of Reproductive Health Professionals designates this educational activity for a maximum of 3.5 AMA PRA Category 1 Credits™. Physicians should only claim credit commensurate with the extent of their participation in the activity.

This activity has been reviewed and is acceptable for up to 3.50 Prescribed credits by the American Academy of Family Physicians.

General Conference

The Association of Reproductive Health Professionals designates this educational activity for a maximum of 20.25 AMA PRA Category 1 Credits™. Physicians should only claim credit commensurate with the extent of their participation in the activity.

This activity has been reviewed and is acceptable for up to 20.25 Prescribed credits by the American Academy of Family Physicians.

ARHP has applied for American Congress of Obstetricians and Gynecologists (ACOG) cognate hours (Formal Learning).

Langston, Newmann, Potter, Reeves, Steward, Sufrin, and White have no financial interests or affiliations to disclose.

Planning Committee

Bednarek: Receives fees for promotional services from Bayer, Conceptus, Schering-Plough

Besinque: Consulting fees: Duramed

Burdette: Ownership interest: Dendreon Corp.

Creinin: Consulting fees: Danco, Merck; Contracted research: Bayer, Medicines360

Gilliam: Contracted research: Merck

Godfrey: Fees for promotional services: Merck

Harper: Contracted research: TEVA

Lichtenberg: Salary: Family Planning Associates Medical Group, Inc.; Royalty: Management of Unintended and Abnormal Pregnancy: Comprehensive Abortion Care

Meckstroth: Other: honoraria from Danco

Berenson, Cappiello, Clark, Downing, Edelman, Espey, Finer, Fjerstad, Forcier, Foster, Gordon, Hathaway, Jordan, Klein, Kumar, Leeman, Ogburn, Teal, Trussell, Turok, Whitaker, Wu, and Zite have no financial interests or affiliations to disclose.

ARHP Staff

Brown, Cohen, Everitt, Glispie, Gordon, Harris, Henry, Holman, Jordan, Kennedy, Robbins, Sager, Shields, and Swann have no financial interests or affiliations to disclose.

PPFA Staff

Nucatola: Fees for non-CME services: TEVA, Organon

Shea: Ownership interest: Hologic

Cipollone, Cullins, Eldredge-Martin, Graziani, Hennessy, Majokowski, Morfesis, Nshom, Patel, Talmont, Wilhelm, and Worthington have no financial interests or affiliations to disclose.

SFP Staff

Higginbotham, Polonsky, and Sot have no financial interests or affiliations to disclose.

Attendee Agreements

By attending *Reproductive Health 2010*, you acknowledge that you may appear in photographs taken by conference staff. All conference photographs are eligible for promotional use at the discretion of the conference staff. Photographs posted to the conference Web site and conference photo gallery (via Flickr) will be removed upon request. You also acknowledge that *Reproductive Health 2010* content, attendees, and other details are confidential and agree not to post meeting details on Web sites, blogs, social networking sites, etc.

Irvin M. Cushner Lectureship

What Should Comprise the Abortion Experience?

Carole Joffe, PhD

Thursday, September 23, 10:45 am

Society of Family Planning Lifetime Achievement Award

Changing Clinical Protocols to Improve Patient-Centered Care: Breaking the Rules

Carolyn Westhoff, MD

Thursday, September 23, 2:00 pm

Allan Rosenfield Award for Lifetime Contributions to International Family Planning

Achieving the Millennium Development Goals: The Impact of Population and Family Planning

Herbert B. Peterson, MD, FACOG

Thursday, September 23, 2:45 pm

Alan F. Guttmacher Lectureship

Where the Rubbers Meet the Road: Title X Turns 40

Kirtly Parker Jones, MD

Friday, September 24, 8:15 am

Michael S. Burnhill Lectureship

The Past as Prologue...

Kenneth C. Edelin, MD

Saturday, September 25, 8:00 am

Miriam Manisoff Award

Bonnie K. Smith, RN, BSN, WHNP-BC

Planned Parenthood of Houston & Southeast Texas

Presented at the PPFA National Medical Conference Luncheon

Saturday, September 25, 12:00 pm

Sylvia Clark Award

Planned Parenthood of the Heartland

Presented at the PPFA National Medical Conference Luncheon

Saturday, September 25, 12:00 pm

Special Assistance

The *Reproductive Health 2010* staff wishes to ensure that no individual with a disability is excluded, denied services, segregated, or otherwise treated differently from other individuals because of the absence of auxiliary aids or services identified in the Americans with Disabilities Act. Please notify us of your needs at the registration desk, located on the ballroom level.

Faculty and Moderators

Bunning: Fees for promotional services: Takeda

Creinin: Consulting fees: Danco, Merck; Contracted research: Bayer, Medicines360

Dominguez: Consulting fees and fees for promotional services: Bayer, Boehringer Ingelheim, TEVA

Drey: Implanon trainer, though does not receive compensation

Gilliam: Contracted research: Merck

Godfrey: Fees for promotional services: Merck

Jamshidi: Fees for promotional services: Schering-Plough

Jones: Consulting fees: Hologic

Kottke: Consulting fees: Schering-Plough; Contracted research: Medicines360, TEVA

Mishell: Consulting fees: Bayer, TEVA

Nucatola: Fees for non-CME services: TEVA, Organon

Raymond: Consulting fees: Watson; Contracted research: HRA Pharma

Shea: Ownership interest: Hologic

Westhoff: Consulting fees: Bayer, Duramed, Merck; Contracted research: Medicines360, Merck, Pfizer

Amy, Bauer, Callaghan, Curtis, Edelin, Edelman, Finer, Fjerstad, Foster, Goodman, Gordon, Grossman, Harwood, Higginbotham, Holmquist,

Howard, Jacobson, Joffe, Lackritz, Miller, Murphy, Nicholas, Policar, Reeves, Schultz, Shih, Swica, Taylor, Trussell, Turok, Vargas, and Wiebe

have no financial interests or affiliations to disclose.

Oral Abstract Presenters

Bednarek: Receives fees for promotional services from Bayer, Conceptus, Schering-Plough

Blumenthal: Performs contracted research for Medicines360

Castleman: Salary: Ipas

Creinin: Consulting fees: Danco, Merck; Contracted research: Bayer, Medicines360

Madden: Fees for promotional services: Bayer

Bonny, Castaño, Cremer, Graseck, Guerrero, Hall, Harrington, Howard,

HYATT REGENCY ATLANTA

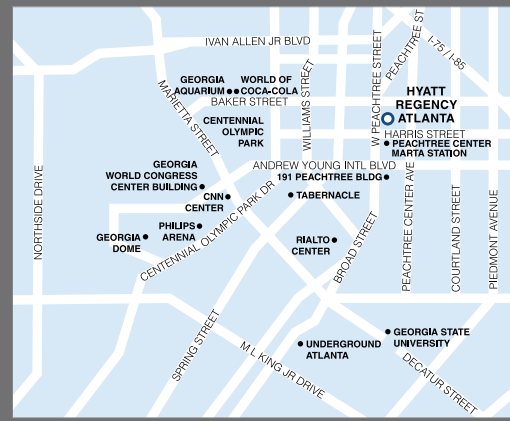

Ballroom Level

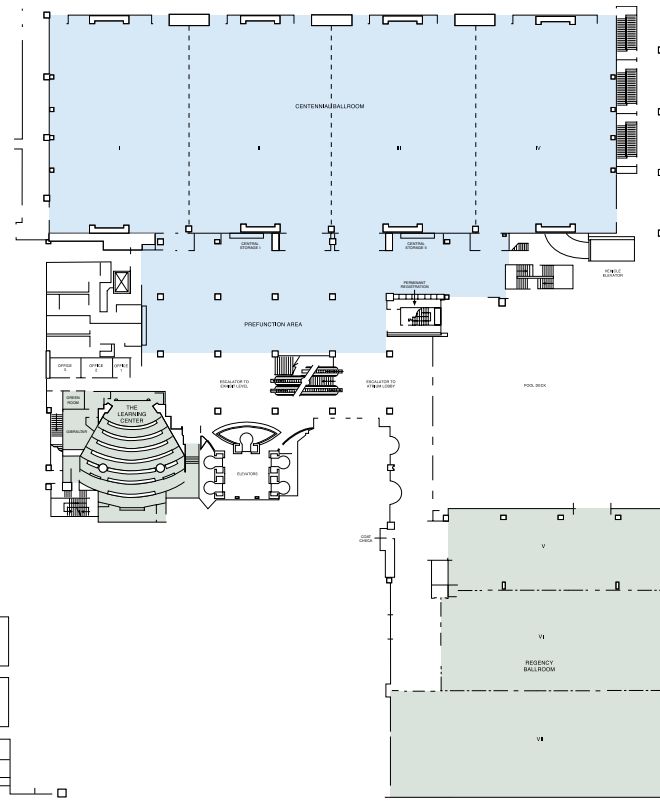
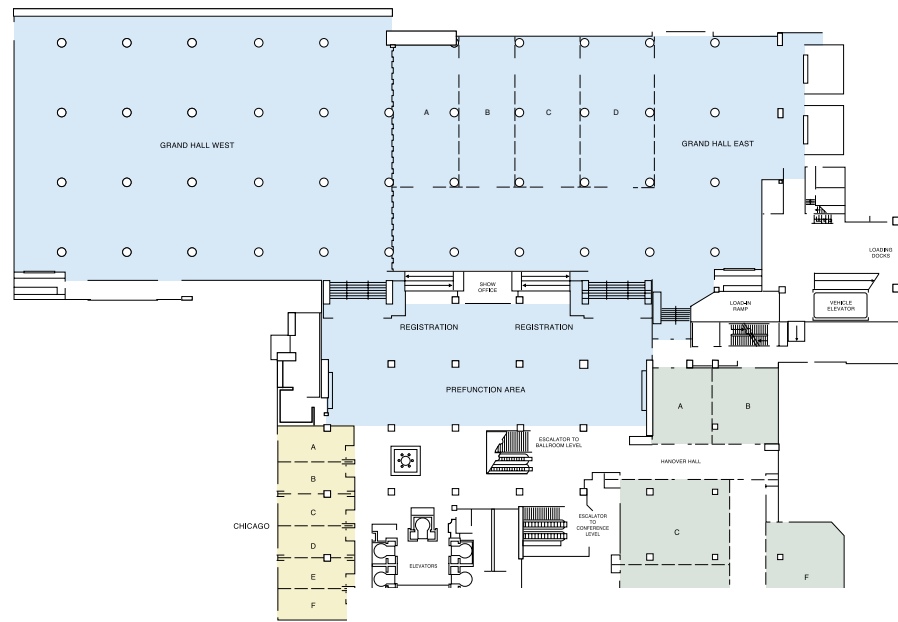
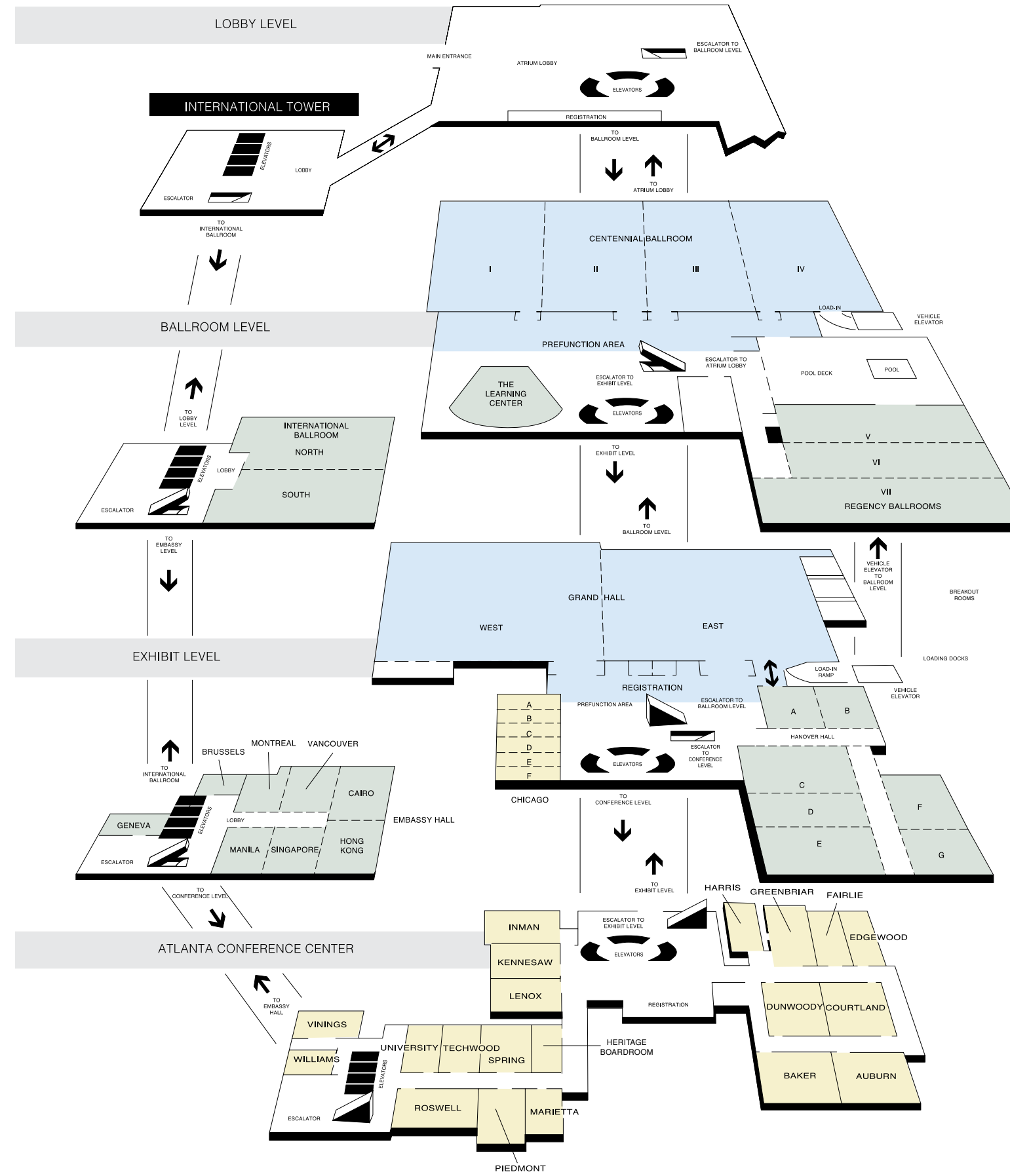

Exhibit Level



Atlanta Conference Level



Jean-Jacques Amy
European Journal of Contraception
and Reproductive Health Care
Ternat, Belgium

Heidi Bauer, MD, MS, MPH
California Department of Public Health,
STD Control Branch
Richmond, CA

Robert Bunning, MD, FACP, FACR
National Rehabilitation Hospital
Washington, DC

Linda Burdette, MPAS, PA-C, DFAAPA
Premier Women's Health of Yakima
Yakima, WA

William M. Callaghan, MD, MPH
Centers for Disease Control and Prevention
Atlanta, GA

Mitchell D. Creinin, MD
Magee-Womens Hospital
Pittsburgh, PA

Kate Curtis, PhD, MSPH
Centers for Disease Control and Prevention
Atlanta, GA

Linda Dominguez, RN-C, NP
Southwest Women's Health
Albuquerque, NM

Eleanor Drey, MD, EdM
University of California, San Francisco
Oakland, CA

Kenneth C. Edelin, MD
Boston University School of Medicine
Boston, MA

Alison Edelman, MD, MPH
Oregon Health & Science University
Portland, OR

Lawrence B. Finer, PhD
Guttmacher Institute
New York, NY

Mary Fjerstad, RN, BSN, MHS, NP
Ipas
Chapel Hill, NC

Angel M. Foster, DPhil, MD, AM
Ibis Reproductive Health
Cambridge, MA

Melissa Gilliam, MD, MPH
University of Chicago
Chicago, IL

Emily Godfrey, MD, MPH
Centers for Disease Control and
Prevention
Atlanta, GA

Suzan Goodman, MD, MPH
University of California, San Francisco
Oakland, CA

Rivka Gordon, PA-C, MHS
Association of Reproductive Health
Professionals
Oakland, CA

Richard Grossman, MD, MPH, FACOG
Four Corners OBGYN
Durango, CO

Bryna Harwood, MD, MS
University of Illinois, Chicago
Chicago, IL

Susan Higginbotham, MEd
Society of Family Planning
Philadelphia, PA

Sabrina Holmquist, MD, MPH
University of Chicago
Chicago, IL

Marion Howard, PhD
Emory University School of Medicine
Atlanta, GA

Jay Jacobson, MD, FACP
LDS Hospital
Salt Lake City, UT

Roxanne Jamshidi, MD, MPH
Johns Hopkins Bayview Medical Center
Baltimore, MD

Carole Joffe, PhD
University of California, San Francisco
Oakland, CA

Kirtly Parker Jones, MD
University of Utah Medical Center
Salt Lake City, UT

Beth Jordan, MD
Association of Reproductive
Health Professionals
Washington, DC

Melissa Kottke, MD
Emory University School of Medicine
Atlanta, GA

Eve Lackritz, MD
Centers for Disease Control and Prevention
Atlanta, GA

Elizabeth Miller, MD, PhD
University of California at Davis School
of Medicine
Sacramento, CA

Daniel R. Mishell, Jr., MD
University of Southern California
Los Angeles, CA

Molly K. Murphy, MPH
Emory University School of Medicine
Atlanta, GA

**Patricia Aikins Murphy, CNM,
DrPH, FACN**
University of Utah College of Nursing
Salt Lake City, UT

Deborah Nicholas, NP
Kaiser Permanente
Richmond, CA

Mark Nichols, MD
Oregon Health & Science University
Portland, OR

Deborah Nucatola, MD
Planned Parenthood Federation
of America, Inc.
New York, NY

Willie J. Parker, MD, MPH
Washington Hospital Center
Washington, DC

Jeff Peipert, MD, MPH
Washington University School of Medicine
St. Louis, MO

Herbert B. Peterson, MD, FACOG
University of North Carolina
Chapel Hill, NC

Michael S. Policar, MD, MPH
University of California, San Francisco
San Francisco, CA

Elizabeth G. Raymond, MD, MPH
Family Health International
Research Triangle Park, NC

Matthew F. Reeves, MD, MPH
WomanCare Global LLC
Washington, DC

Erin Cassard Schultz, JD
University of California, San Francisco
Oakland, CA

Karen Shea, MSN, WHNP-BC
Planned Parenthood Federation
of America, Inc.
New York, NY

Wayne C. Shields
Association of Reproductive
Health Professionals
Washington, DC

Grace Shih, MD
University of California, San Francisco
Oakland, CA

Scott J. Spear, MD, FAAP
Planned Parenthood of the
Texas Capital Region
Austin, TX

Yael Swica, MD, MPH
Gynuity Health Projects
New York, NY

Diana Taylor, RN, NP, PhD, FAAN
UCSF School of Nursing
San Francisco, CA

Michael A. Thomas, MD
University of Cincinnati Medical Center
Cincinnati, OH

James Trussell, BPhil, PhD
Princeton University
Princeton, NJ

David Turok, MD, MPH
University of Utah
Salt Lake City, UT

Juan E. Vargas, MD
University of California, San Francisco
San Francisco, CA

Tracy Weitz, PhD, MPA
University of California, San Francisco
Oakland, CA

Carolyn Westhoff, MD
Columbia University Medical Center
New York, NY

Ellen Wiebe, MD
Willow Women's Clinic
Vancouver, BC

**Sandy Worthington, MSN,
WHNP-BC, CNM**
Planned Parenthood Federation
of America, Inc.
New York, NY

Justine Wu, MD, MPH
Robert Wood Johnson University Hospital
New Brunswick, NJ

Stephen S. York, JD
McAloon & Friedman
New York, NY

Paula Bednarek, MD, MPH
Paul Blumenthal, MD, MPH
Andrea Bonny, MD

Paula Castaño, MD, MPH
Laura Castleman, MD, MPH, MBA
Mitchell D. Creinin, MD

Miriam Cremer, MD, MPH
Anna Graseck, MD

Jacqueline Guerrero, MD
Kelli Stidham Hall, PhD, MSN, NP
Elizabeth Harrington

Marion Howard, PhD
Aileen M. Langston, MD, MPH
Tessa Madden, MD, MPH

Sara Newmann, MD, MPH
Joseph E. Potter, PhD

Matthew F. Reeves, MD, MPH
Rachel Steward, MD
Carolyn Sufrin, MD, MA

Dilys Walker, MD
Katharine O'Connell White, MD, MPH

Executive Planning Committee

Eve Espey, MD, MPH
Co-chair of Abstract Review Committee
 University of New Mexico
 Albuquerque, NM

Mary Fjerstad, RN, BSN, MHS, NP
 Ipas
 Chapel Hill, NC

Melissa Gilliam, MD, MPH
Co-chair of Abstract Review Committee
 University of Chicago
 Chicago, IL

Rivka Gordon, PA-C, MHS
 Association of Reproductive
 Health Professionals
 Oakland, CA

Mark Hathaway, MD, MPH
*Chair of Conflict of Interest
 Subcommittee*
 Washington Hospital Center
 Washington, DC

Beth Jordan, MD
Chair of Clinical Content Subcommittee
 Association of Reproductive Health
 Professionals
 Washington, DC

E. Steve Lichtenberg, MD, MPH
 Planned Parenthood Federation of America
 National Medical Committee
 Chicago, IL

Justine Wu, MD, MPH
 Robert Wood Johnson University Hospital
 New Brunswick, NJ

Clinical Content Subcommittee

Linda Burdette, MPAS, PA-C, DFAAPA
 Premier Women's Health of Yakima
 Yakima, WA

Barb Clark, PA-C, MPAS
 Knox OB/GYN, Ltd.
 Galesburg, IL

Michelle Forcier, MD, MPH
 Rhode Island Hospital/Hasbro
 Children's Hospital
 Providence, RI

Karen Meckstroth, MD, MPH
 University of California, San Francisco
 San Francisco, CA

James Trussell, BPhil, PhD
 Princeton University
 Princeton, NJ

Conflict of Interest Subcommittee

Joyce Cappiello, APRN
 Feminist Health Center
 Barrington, NH

Don Downing, RPh
 University of Washington
 Seattle, WA

Wendy Klein, MD, FACP
 Virginia League for Planned Parenthood
 Richmond, VA

Abstract Review Committee

Paula Bednarek, MD, MPH
 Oregon Health & Science University
 Portland, OR

Abbey Berenson, MD, MMS
 University of Texas Medical Branch
 Galveston, TX

Kathleen Besinque, PharmD, MSEd, FASHP
 University of Southern California
 Los Angeles, CA

Mitchell D. Creinin, MD
 Magee-Womens Hospital
 Pittsburgh, PA

Christine Dehlendorf, MD
 University of California, San Francisco
 San Francisco, CA

Alison Edelman, MD, MPH
 Oregon Health & Science University
 Portland, OR

Lawrence B. Finer, PhD
 Guttmacher Institute
 New York, NY

Mary Fjerstad, RN, BSN, MHS, NP
 Ipas
 Chapel Hill, NC

Angel M. Foster, DPhil, MD, AM
 Ibis Reproductive Health
 Cambridge, MA

Emily Godfrey, MD, MPH
 Centers for Disease Control and Prevention
 Atlanta, GA

Daniel Grossman, MD
 Ibis Reproductive Health
 San Francisco, CA

Cynthia Harper, PhD
 University of California, San Francisco
 San Francisco, CA

Jeff Jensen, MD
 Oregon Health & Science University
 Portland, OR

Rachel Jones, PhD
 Guttmacher Institute
 New York, NY

Anu Kumar, PhD, MPH
 Ipas
 Chapel Hill, NC

Larry Leeman, MD, MPH
 University of New Mexico
 Albuquerque, NM

Mark Nichols, MD
 Oregon Health & Science University
 Portland, OR

Deborah Nucatola, MD
 Planned Parenthood Federation
 of America, Inc.
 New York, NY

Tony Ogburn, MD
 University of New Mexico
 Albuquerque, NM

Joseph E. Potter, MPA, PhD
 University of Texas
 Austin, TX

Matthew F. Reeves, MD, MPH
 WomanCare Global LLC
 Washington, DC

Kate Sheehan, MD
 Planned Parenthood of San Diego
 and Riverside Counties
 San Diego, CA

Jody Steinauer, MD, MAS
 University of California, San Francisco
 San Francisco, CA

Diana Taylor, RN, NP, PhD, FAAN
 UCSF School of Nursing
 San Francisco, CA

Stephanie Teal, MD, MPH
 University of Colorado
 Denver, CO

David Turok, MD, MPH
 University of Utah
 Salt Lake City, UT

Amy Whitaker, MD, MS
 University of Chicago
 Chicago, IL

Justine Wu, MD, MPH
 Robert Wood Johnson University Hospital
 New Brunswick, NJ

Nikki Zite, MD, MPH
 University of Tennessee Medical Center
 Knoxville, TN

Host Committee

Nancy Boothe, RN, MS
 Feminist Women's Health Center
 Atlanta, GA

Johanna Chapin

Carrie Cwiak, MD, MPH
 Emory University School of Medicine
 Atlanta, GA

Mary Driscoll
 Planned Parenthood Southeast
 Atlanta, GA

Joel S. Engel, MD
 Planned Parenthood Southeast
 Atlanta, GA

Tawana Evans, RN
 Planned Parenthood Southeast
 Atlanta, GA

Robert A. Hatcher, MD, MPH
 Emory University School of Medicine
 Atlanta, GA

Melissa Kottke, MD
 Emory University School of Medicine
 Atlanta, GA

Judy Lipshutz, MD, MPH
 Centers for Disease Control and Prevention
 Atlanta, GA

Miriam Ziemann, MD
 Emory University School of Medicine
 Atlanta, GA

EXHIBITORS

GOLD

Bayer HealthCare Pharmaceuticals
 TEVA Women's Health
 Hologic LP
 Merck and Company, Inc.
 Watson

SILVER

LabCorp

GENERAL/NON-PROFIT

Abortion Clinics OnLine/Clinic Pages
 Abortion Access Fund
 Association of Reproductive
 Health Professionals
 Boulder Abortion Clinic, P.C.
 Center for Disease Detection, LLC
 Conceptus, Inc.
 Danco Laboratories, LLC
 Elsevier
 Family Violence Prevention Fund
 Feminist Women's Health Center
 HPSRx Enterprise, Inc.
 Infant Adoption Training Initiative
 MedGyn Products
 National Abortion Federation
 National Association of Nurse
 Practitioners in Women's Health
 National Family Planning and
 Reproductive Health Association
 Office of Population Affairs
 Clearinghouse
 Pfizer
 Planned Parenthood Federation
 of America, Inc.
 Ryan Residency Training Program
 Society of Family Planning
 WomanCare Global, LLC

SUPPORTERS

Allergan, Inc.
 Astellas Pharma Inc.
 Boehringer Ingelheim
 Danco Laboratories, LLC
 Graceway Pharmaceuticals
 Ipas
 John Merck Fund
 Merck and Company, Inc.
 Passport Foundation
 Pfizer
 QIAGEN
 Richard and Rhoda Goldman Fund
 TEVA Women's Health
 The Educational Foundation of America
 Wyeth Pharmaceuticals

AGENDA AT A GLANCE

Wednesday, September 22	
Afternoon	Concurrent, Accredited Pre-conference Sessions
	SFP's Career Development Seminar: <i>How to Write Grants</i>
Evening	ARHP Board Meeting and Dinner
	SFP Board Meeting and Dinner
	Welcome Reception
Friday, September 24	
Morning	Breakfast with Exhibitors
	Late Breaking Reproductive Health Updates
Afternoon	Plenary Session III
	National Medical Committee Members and Liaison Luncheon <i>(by invitation only)</i>
	PPFA/ARMS Clinicians' Lunch <i>(Planned Parenthood staff/volunteers only)</i>
	Lunch with Exhibitors and Product Theater
	PPFA Clinical Issues Discussions, Part I <i>(open to all Reproductive Health 2010 attendees)</i>
	Concurrent Breakout Session I
Evening	Poster and Awards Reception and Book Signing
	Medical Directors Council (MeDC) Meeting <i>(Planned Parenthood medical directors only)</i>
	SFP Mentor Project Social <i>(SFP Fellows only)</i>

Thursday, September 23	
<i>Exhibits and posters set up all day in Grand Hall West</i>	
Morning	Breakfast with Exhibitors
	Welcome Remarks
	Plenary Session I
Afternoon	Concurrent, Accredited Lunch and Learn Sessions
	Plenary Session II
Evening	Reinventing <i>Reproductive Health</i> Focus Group <i>(open to all Reproductive Health 2010 attendees)</i>
	SFP Business Meeting
	PPFA NPSC Reception <i>(Planned Parenthood staff/volunteers only)</i>
	SFP Reception <i>(SFP Fellows and Junior Fellows only)</i>
	SFP Dinner <i>(SFP Fellows only)</i>
Saturday, September 25	
Morning	Breakfast
	Late Breaking Reproductive Health Updates
	Plenary Session IV
	PPFA Clinical Issues Discussions, Part II <i>(Planned Parenthood staff/volunteers only)</i>
Afternoon	Concurrent Breakout Session II
	<i>Reproductive Health 2010</i> concludes
Evening	PPFANMC Luncheon and Award Presentation <i>(Planned Parenthood staff/volunteers only)</i>
	PPFANMC Work Group Meetings <i>(Planned Parenthood staff/volunteers only)</i>
	New Medical Directors' Orientation <i>(Planned Parenthood staff/volunteers only)</i>
	The George Tiller Memorial Reception at the PPFA National Medical Conference <i>(Planned Parenthood staff/volunteers only)</i>
Sunday, September 26 <i>(PPFANMC sessions only)</i>	
Morning	Breakfast
	NMC subcommittee presentations, reports and final discussions <i>(Planned Parenthood staff/volunteers only)</i>
	PPFA National Medical Conference concludes

Don't miss the **Product Theater** presentation in the exhibit hall on Friday from 1:00-2:00. Representatives from Conceptus, Inc., including **Tamara Callahan, MD of Vanderbilt University**, will demonstrate their permanent birth control method, Essure, with a presentation titled **Hysteroscopic Sterilization in the Office Setting: The New Standard of Care.**

The Product Theater is a promotional activity and is not approved for continuing education credit. The content of the Product Theater expressed by presenters are those of the host or presenters and not those of the Conference Partners. The Conference Partners do not endorse or co-sponsor the Product Theater.

EXHIBIT HOURS

Be sure to meet the *Reproductive Health 2010* exhibitors. The exhibit hall will be open all day Thursday and Friday and dedicated time has been included in the agenda to make sure you have time to visit each booth, including:

- **Wednesday evening during the Welcome Reception (7:30-8:30)**
- **Thursday morning during breakfast (7:00-7:45) and at the break (10:15-10:45)**
- **Friday morning during breakfast (6:30-8:10) and at the break (10:45-11:15)**
- **Friday afternoon during the lunch with exhibitors (1:00-2:00)**
- **Friday evening during the Poster and Awards Reception (4:30-6:00)**

We invite you to visit our “take one” table at www.ReproductiveHealth2010.org.

Resources provided by:
 Jacobs Institute of Women's Health
 RESOLVE: The National Infertility Association
 San Francisco Department of Public Health's Go Folic!
 Women's Nutrition Project Touch Briefings

VIRTUAL
TAKE ONE
TABLE

Looking for a comfortable and private place to pump or nurse?

See a conference staff person at the registration desk for information regarding the dedicated lactation room.

LACTATION ROOM

Posters will be displayed all day
Thursday, September 23 and Friday, September 24.

POSTER PRESENTATIONS

POSTER PRESENTATIONS

- | | | | | | | | |
|-----|---|-----|--|-----|--|-----|---|
| P01 | A RANDOMIZED TRIAL OF IMMEDIATE VERSUS DELAYED INSERTION OF THE COPPER T 380Q FOLLOWING MEDICATION ABORTION | P19 | CARBAMAZEPINE COADMINISTRATION WITH AN ORAL CONTRACEPTIVE: EFFECTS ON STEROID PHARMACOKINETICS, OVULATION AND BLEEDING | P36 | IUD REMOVALS IN THE EMERGENCY DEPARTMENT SETTING | P56 | ARE THERE DIFFERENCES? SHBG LEVELS, FREE TESTOSTERONE AND SEXUAL PAIN IN WOMEN USING COMBINED HORMONAL CONTRACEPTION: A RETROSPECTIVE STUDY IN VULVODYNIA PATIENTS |
| P02 | PAIN FOLLOWING POST-ASPIRATION IUD INSERTION | P20 | WHAT DO WOMEN WANT? WOMEN'S EXPERIENCES AND PREFERENCES ABOUT CONTRACEPTIVE COUNSELING: A QUALITATIVE STUDY | P37 | RATES OF INTRAUTERINE DEVICE DISCONTINUATION AFTER ABORTION VS. INTERVAL PLACEMENT | P57 | PARTNERSHIP CHARACTERISTICS AS PREDICTORS FOR CHOOSING A VERY EFFECTIVE CONTRACEPTIVE METHOD |
| P03 | USING QUALITATIVE METHODS TO EXPLORE EC USERS WILLINGNESS TO ACCEPT THE COPPER IUD | P21 | PAIN WITH IUD INSERTION FOLLOWING PROPHYLACTIC IBUPROFEN: A RANDOMIZED TRIAL | P38 | METHOD SATISFACTION AMONG USERS OF POST PARTUM IUD IN EL SALVADOR | P58 | UNMET DEMAND FOR STERILIZATION AMONG LATINAS |
| P04 | TRANSCESAREAN IUD INSERTION: A PROSPECTIVE COHORT STUDY | P22 | US ADOLESCENT EXPERIENCE WITH INTRAUTERINE DEVICE INSERTION AND USE: A RETROSPECTIVE STUDY | P39 | OVARIAN SUPPRESSION IN NORMAL-WEIGHT AND OBESE WOMEN USING A CONTRACEPTIVE VAGINAL RING | P59 | EXAMINING THE INFLUENCE OF MATERNAL CHARACTERISTICS ON THE USE OF CONTRACEPTION AFTER ABORTION IN THE UNITED STATES USING THE 2002 NATIONAL SURVEY OF FAMILY GROWTH |
| P05 | RATES OF EXPULSION AT 6 MONTHS IN WOMEN UNDERGOING IMMEDIATE POSTABORTION INTRAUTERINE CONTRACEPTION INSERTION | P23 | EMERGENCY CONTRACEPTION KNOWLEDGE AND LIKELIHOOD OF USE BY WOMEN WITH RECENT POOR PERINATAL OUTCOMES | P40 | OVARIAN FOLLICULAR DEVELOPMENT DURING SIX WEEK EXTENDED USE OF A SINGLE CONTRACEPTIVE VAGINAL RING | P60 | MEDICAL VERSUS SURGICAL ABORTION: THE IMPORTANCE OF WOMEN'S CHOICE |
| P06 | ESTIMATED COST SAVINGS WITH PROVIDING UNIVERSAL CONTRACEPTION IN THE STATE OF OREGON | P24 | CONTRACEPTIVE CHOICES IN PATIENTS WITH LOW LITERACY SKILLS | P41 | CONTINUATION AND ACCEPTABILITY OF THE LEVONORGESTREL INTRAUTERINE SYSTEM AND DEPO-MEDROXYPROGESTERONE ACETATE AMONG ADOLESCENTS AND YOUNG WOMEN | P61 | WOMEN'S ATTITUDES AND BEHAVIORS TOWARD UNPLANNED PREGNANCY: A PROSPECTIVE STUDY |
| P07 | PREDICTORS OF PATIENT USE OF HIGHLY EFFECTIVE POST-PARTUM CONTRACEPTION | P25 | WHAT FACTORS INFLUENCE WOMEN'S CONTRACEPTIVE DECISIONS? | P42 | THE EFFECT OF PARITY ON REASONS FOR REMOVAL OF A LEVONORGESTREL IUS | P62 | CHANGES IN SERVICE DELIVERY PATTERNS AFTER LAUNCHING TELEMEDICINE PROVISION OF MEDICATION ABORTION IN IOWA |
| P08 | EFFECTS OF ST. JOHN'S WORT ON THE PHARMACOKINETICS OF LEVONORGESTREL IN EMERGENCY CONTRACEPTIVE (EC) DOSING | P26 | FAMILY PLANNING PROVIDER ATTITUDES AND PRACTICES RELATED TO PROVISION OF CONTRACEPTIVE METHODS AMONG WOMEN WITH VARIOUS CHARACTERISTICS AND MEDICAL CONDITIONS | P43 | SELF-ADMINISTRATION OF SUBCUTANEOUS DEPOT MEDROXYPROGESTERONE ACETATE BY ADOLESCENT WOMEN | P63 | HAS MIFEPRISTONE MEDICAL ABORTION EXPANDED ABORTION ACCESS IN NEW MEXICO? A SURVEY OF OB/GYN AND FAMILY MEDICINE PHYSICIANS |
| P09 | EVALUATION OF ORAL CONTRACEPTIVE EFFECTIVENESS IN A LARGE COHORT STUDY — IS ELEVATED BMI ASSOCIATED WITH REDUCED ORAL CONTRACEPTIVE EFFECTIVENESS? | P27 | MEDICAL STUDENT INTRAUTERINE CONTRACEPTION KNOWLEDGE AND ATTITUDES: EVALUATION OF OBSTETRIC AND GYNECOLOGY CLERKSHIP TRAINING | P44 | PROVISION OF POSTPARTUM CONTRACEPTION IN WOMEN WITH CHRONIC MEDICAL CONDITIONS | P64 | REPRODUCTIVE HEALTH PROGRAM: OUTCOMES OF A UNIQUE ABORTION TRAINING PROGRAM |
| P10 | COMPARING THE CONTRACEPTIVE DECISION-MAKING OF WOMEN WHO CHOOSE AN INTRAUTERINE DEVICE VERSUS A LESS EFFECTIVE METHOD: A QUALITATIVE ANALYSIS | P28 | ASSOCIATION OF AGE AND LARC METHOD CHOICE IN THE CONTRACEPTIVE CHOICE PROJECT | P45 | USE OF A SELF-ADMINISTERED COMPUTER MODULE PROVIDING PERSONALIZED CONTRACEPTIVE RECOMMENDATIONS IN A CLINICAL SETTING | P65 | "ARE WE EVEN SPEAKING THE SAME LANGUAGE?": CONTESTED DEFINITIONS OF RAPE, INCEST, AND LIFE ENDANGERMENT UNDER THE HYDE AMENDMENT |
| P11 | COMPARING OUTCOMES FOLLOWING IMMEDIATE OR DELAYED LEVONORGESTREL-IUD INSERTION AFTER DILATION AND CURETTAGE, DILATION AND EVACUATION AND VAGINAL DELIVERY | P29 | UNMET NEED FOR PUBLICLY FUNDED FAMILY PLANNING IN REGION IV | P46 | COST ANALYSIS OF HYSTEROSCOPIC STERILIZATION VERSUS THE INTRAUTERINE DEVICE AS LONG-TERM CONTRACEPTION | P66 | STANDARDIZING EARLY ABORTION COMPLICATION DEFINITIONS AND TRACKING: TESTING AN EVIDENCE-BASED FRAMEWORK |
| P12 | CONTRACEPTIVE USE AMONG WOMEN OBTAINING ABORTIONS IN 2008 | P30 | PREVALENCE OF CHLAMYDIA TRICHOMATIS AND NEISSERIA GONORRHOEA IN PATIENTS REQUESTING IUD AS POST ABORTION CONTRACEPTION IN A PUBLICLY FUNDED PREGNANCY TERMINATION CLINIC | P47 | IBUPROFEN PROPHYLAXIS FOR LEVONORGESTREL-RELEASING INTRAUTERINE SYSTEM INSERTION: A RANDOMIZED CONTROLLED TRIAL | P67 | OVULATION RESUMPTION AFTER MEDICAL ABORTION WITH MIFEPRISTONE AND MISOPROSTOL |
| P13 | COUPLES-BASED FAMILY PLANNING SERVICES: IS THERE A NEED? | P31 | GIVING YOUNG WOMEN IN KENYA AN OPPORTUNITY TO USE IMPLANTS INSTEAD OF SHORT-ACTING METHODS: PROSPECTIVE STUDY TO MEASURE ACCEPTABILITY AND BENEFITS | P48 | PROVIDER OPINIONS ABOUT EXPANDING ACCESS TO HORMONAL CONTRACEPTION | P68 | PRELIMINARY RESULTS OF THE ROLE OF SEMIQUANTITATIVE PREGNANCY TESTS IN MEDICAL ABORTION PROVISION |
| P14 | LEVONORGESTREL RELEASE RATES WITH LNG20, A NEW LEVONORGESTREL INTRAUTERINE SYSTEM, AND MIRENA | P32 | FACTORS ASSOCIATED WITH CHOOSING A LONG ACTING REVERSIBLE CONTRACEPTIVE METHOD AMONGST POSTPARTUM WOMEN IN AN URBAN TEACHING HOSPITAL | P49 | NUMBER OF ORAL CONTRACEPTIVE PILL PACKAGES DISPENSED AND SUBSEQUENT UNINTENDED PREGNANCIES | P69 | PREVENTING REPEAT ABORTION: IS THE IMMEDIATE INSERTION OF INTRAUTERINE DEVICES POST-ABORTION ASSOCIATED WITH FEWER REPEAT ABORTIONS IN A CANADIAN POPULATION? |
| P15 | KNOWLEDGE OF CONTRACEPTIVE EFFECTIVENESS AMONG A COHORT OF ST. LOUIS WOMEN CHOOSING REVERSIBLE CONTRACEPTION | P33 | EFFECT OF SUBCUTANEOUS DEPO-MEDROXYPROGESTERONE ACETATE SUBCUTANEOUS (DEPOT-MEDROXYPROGESTERONE ACETATE) ON SERUM ANDROGENIC MARKERS IN NORMAL WEIGHT, OBESE AND EXTREMELY OBESE WOMEN | P50 | LENGTH OF TIME AFTER INSERTION FOR THE LEVONORGESTREL-RELEASING INTRAUTERINE SYSTEM FOR IT TO SIGNIFICANTLY ALTER CERVICAL MUCUS QUALITY AND SPERM PENETRABILITY | P70 | DILATION AND EVACUATION VS. LABOR INDUCTION FOR FETAL INDICATIONS: A RETROSPECTIVE COHORT STUDY |
| P16 | PLASMA LEVONORGESTREL LEVELS IN WOMEN USING LNG20, A NEW LEVONORGESTREL INTRAUTERINE SYSTEM, AND MIRENA | P34 | BARRIERS TO CONTRACEPTIVE USE IN TASBA-PRI, NICARAGUA | P51 | CONTRACEPTIVE CHOICES OF ADOLESCENTS IN A LARC-ORIENTED ADOLESCENT TITLE X CLINIC | P71 | ABORTION PRACTICE AND NEED FOR TRAINING IN MEXICO: RESULTS FROM A SURVEY OF MEXICAN PROVIDERS AT THE 2009 ANNUAL OBSTETRICS AND GYNECOLOGY SPECIALTY CONFERENCE |
| P17 | CONTINUATION AND SATISFACTION OF REVERSIBLE CONTRACEPTION: A PRELIMINARY ANALYSIS FROM THE CONTRACEPTIVE CHOICE PROJECT | P35 | COMMUNITY-BASED PROVISION OF DMPA IN TIGRAY, ETHIOPIA: TASK SHIFTING TO REACH WOMEN | P52 | BARRIERS TO POST-PARTUM IUC USE: IMPLICATIONS FOR PATIENT CONTRACEPTIVE PREFERENCES AND SATISFACTION WITH HEALTH SERVICES | P72 | CONTRACEPTIVE CHOICES OF OVERWEIGHT AND OBESE WOMEN IN A PUBLICLY FUNDED HOSPITAL: CLINICAL IMPLICATIONS |
| P18 | UNDERSTANDING THE ATTITUDES OF BLACK, LATINO, AND WHITE COUPLES TOWARDS STERILIZATION | | | P53 | THE IMPACT OF INSURANCE COVERAGE ON IUD UTILIZATION | P73 | IMPACT OF GESTATIONAL AGE ON PAIN PERCEPTION DURING FIRST TRIMESTER SURGICAL ABORTION |
| | | | | P54 | CHARACTERISTICS OF WOMEN WHO FAIL TO RETURN FOR DELAYED IUD INSERTION FOR POST-ABORTION CONTRACEPTION | | |
| | | | | P55 | USE OF EFFECTIVE CONTRACEPTIVE METHODS AMONG WOMEN TAKING TERATOGENIC MEDICATIONS FOR SYSTEMIC LUPUS ERYTHEMATOSUS | | |

Posters will be displayed all day
Thursday, September 23 and Friday, September 24.

POSTER PRESENTATIONS

- P74 IMPACT OF A SPECIALTY ROTATION IN FAMILY PLANNING ON OBSTETRICS AND GYNECOLOGY RESIDENTS' SELF-ASSESSMENT OF COMPETENCY AND INTENTIONS TO PROVIDE ABORTION SERVICES AFTER GRADUATION
- P75 THE EXTENDED GESTATIONAL AGE MEDICAL ABORTION STUDY: THE EFFECTIVENESS OF MEDICAL ABORTION WITH MIFEPRISTONE AND MISOPROSTOL AT 57-63 DAYS VERSUS 64-70 DAYS GESTATION
- P76 MUSIC IN SURGICAL ABORTION CARE: A RANDOMIZED CONTROLLED PILOT STUDY
- P77 CAN THE PROSPECT OF INFERTILITY MOTIVATE YOUNG WOMEN'S INTENTIONS TO SEEK PREVENTIVE HEALTHCARE? FINDINGS FROM CDC CONCEPT TESTING FOCUS GROUPS
- P78 HIGH-RISK SEXUAL BEHAVIOUR IN A RANDOM SAMPLE OF >22,000 MEN FROM THE GENERAL POPULATION IN DENMARK
- P79 EXPERIENCES OF DISCRIMINATION AND STI TESTING IN WHITE AND BLACK WOMEN
- P80 MISSED OPPORTUNITIES FOR CHLAMYDIA RETESTING AT LIMITED SERVICE VISITS IN CALIFORNIA FAMILY PLANNING CLINICS
- P81 THE BABOON (PAPIO ANUBIS) AS A NOVEL MODEL OF CHLAMYDIA TRACHOMATIS PELVIC INFLAMMATORY DISEASE FOR TESTING INTRAUTERINE CONTRACEPTION
- P82 IMIQUIMOD 2.5% AND 3.75% APPLIED DAILY FOR UP TO 8 WEEKS TO TREAT EXTERNAL GENITAL WARTS
- P83 ELDERLY PERSON'S REPRODUCTIVE HEALTH CHALLENGES AND INVOLVEMENT IN RISKY SEXUAL ACTIVITIES IN IKORODU, NIGERIA
- P84 PREDICTORS OF SEXUAL SATISFACTION AMONG YOUNG ADULTS IN THE UNITED STATES
- P85 REPRODUCTIVE AND SEXUAL HEALTH IN MENTALLY ILL
- P86 SEXUAL INTIMATE PARTNER VIOLENCE, SEXUAL RISK BEHAVIORS, AND CONTRACEPTIVE PRACTICES AMONG WOMEN OF AFRICAN DESCENT
- P87 REPRODUCTIVE HEALTHCARE NEEDS OF HIV-POSITIVE WOMEN
- P88 CONTRACEPTIVE KNOWLEDGE, ATTITUDES, AND PRACTICES AMONG HIV-INFECTED WOMEN AND MEN RECEIVING HIV CARE AND TREATMENT IN NYANZA PROVINCE, KENYA
- P89 HIGH CONTRACEPTION USE AND LOW PREGNANCY RATE AMONG HIV POSITIVE WOMEN ATTENDING A POSTNATAL PROGRAM IN LILONGWE, MALAWI
- P90 INTRAUTERINE LIDOCAINE INFUSION FOR PAIN MANAGEMENT DURING OUTPATIENT TRANSCERVICAL TUBAL STERILIZATION
- P91 RISK FACTORS FOR AND CONSEQUENCES OF UNINTENDED PREGNANCY AMONG LATINA AND WHITE POPULATIONS IN UTAH, 2004-2007
- P92 COMPARISON OF LNG20, A NEW LEVONORGESTREL INTRAUTERINE SYSTEM, AND MIRENA FOR TREATMENT FOR MENORRHAGIA
- P93 PRESUMPTIVE TREATMENT OF ABNORMAL EARLY PREGNANCY OF UNKNOWN LOCATION
- P94 VAGINAL AND RECTAL CLOSTRIDIAL COLONIZATION AMONG WOMEN OF REPRODUCTIVE AGE IN THE UNITED STATES
- P95 TWO-STAGE CLUSTER SAMPLING WITH REFERRAL: IMPROVING THE EFFICIENCY OF ESTIMATING UNMET NEEDS AMONG PREGNANT AND POSTPARTUM WOMEN AFTER FLOODING IN NORTHWEST GEORGIA, SEPTEMBER 2009
- P96 RURAL REPRODUCTIVE HEALTH: BARRIERS AND FACILITATORS EXPERIENCED BY LOW-INCOME RURAL WOMEN IN OBTAINING REPRODUCTIVE HEALTH CARE SERVICES
- P97 EFFECT OF A "CONTRACEPTIVE VITAL SIGN" IN PRIMARY CARE: A RANDOMIZED CONTROLLED TRIAL
- P98 ASSOCIATION BETWEEN ECONOMIC VULNERABILITY AND WOMEN'S PREGNANCY INTENTIONS
- P99 IMPACT OF LENGTH OF FORMAL FAMILY PLANNING TRAINING ON SELF-ASSESSED COMPETENCE AND PROCEDURE VOLUME OF ABORTION PROCEDURES
- P100 IMPACT OF FORMAL FAMILY PLANNING TRAINING ON OB-GYN RESIDENTS' SKILLS AND EXPOSURE IN CONTRACEPTION PROVISION
- P101 INNOVATION IN EMERGENCY OBSTETRIC TRAINING, PRONTO2: AN IN SITU MULTI-DISCIPLINARY, LOW-TECH, HIGH-FIDELITY SIMULATION-BASED CURRICULUM FOR MEXICO, RESULTS OF A PILOT IMPLEMENTATION STUDY
- P102 CONTRACEPTION USE AFTER AN UNPLANNED PREGNANCY

ARE YOU CONNECTED?



Committed Providers

Catalyst for Improving Care

Rigorous Science

Multidisciplinary Network



Association of
Reproductive
Health
Professionals

Connect Today at
www.arhp.org/join

Special thanks to members of ARHP's **Corporate Advisory Board (CAB)** for their commitment to high quality reproductive health care and support of ARHP's *Fund for the Future of Reproductive Health*®.



Bayer HealthCare Pharmaceuticals
 Boehringer Ingelheim Pharmaceuticals, Inc.
 Depomed
 Endo Pharmaceuticals
 Ferring Pharmaceuticals
 Hologic LP
 Merck & Company, Inc.
 Ortho Women's Health & Urology
 Pfizer
 QIAGEN
 TEVA Women's Health



Danco Laboratories...
 your partner in reproductive health care.

 DANCO LABORATORIES
 www.earlyoptionpill.com
 1-877-4-EARLY OPTION

Reproductive Health attendees save 20% off list price

The textbook of the
 NATIONAL ABORTION FEDERATION

Edited by:

Maureen Paul, MD, MPH
 Planned Parenthood NYC,
 Mt. Sinai School of Medicine

E. Steve Lichtenberg, MD, MPH
 Northwestern University School
 of Medicine

Lynn Borgatta, MD, MPH
 Boston University School
 of Medicine

David A. Grimes, MD
 University of North Carolina
 School of Medicine

Phillip G. Stubblefield, MD
 Boston University School
 of Medicine

Mitchell D. Creinin, MD
 University of Pittsburgh School
 of Medicine

Hardcover
 400 pp
 ISBN: 978-1-4051-7696-5
 \$141.95

**Save 20%
 off list price
 Enter code
 NAF10
 during
 checkout**

Management of Unintended and Abnormal Pregnancy: Comprehensive Abortion Care



A state-of-the-art textbook that will serve as the standard, evidence-based reference text in abortion care

Management of Unintended and Abnormal Pregnancy: Comprehensive Abortion Care reviews the best surgical and medical practices for pregnancy termination, as well as managing ectopic and other abnormal pregnancies. This textbook:

- is authored by internationally-known leaders in women's health care;
- addresses unintended pregnancy and abortion from historical, legal, public health, clinical, and quality care perspectives;
- includes chapters on pregnancy loss, ectopic pregnancy, gestational trophoblastic disease, and multifetal pregnancy reduction;
- covers treatment of pregnancies in the first and second trimester by both medical and surgical techniques; and
- provides resources for clinical, scientific, and social support for the abortion provider and patient.

**TO ORDER, VISIT NAF'S BOOTH IN THE EXHIBIT HALL OR:
 Call Toll-Free: 877.762.2974 (In Canada 800.567.4797)
 Order Online: www.wiley.com**

HOLOGIC™
The Women's Health Company



We want women everywhere to live longer, stronger, healthier, lives.

Cervical Cancer Screening • Endometrial Ablation
Permanent Contraception • Prenatal Health • Osteoporosis Assessment
Breast Cancer Detection, Diagnosis and Treatment

www.hologic.com

ADS-00345-001 Rev.001

JUST LAUNCHED FROM ARHP

The GO Tool



Connecting health professions students to learning opportunities across the world

Start exploring today at
www.arhp.org/GOTool



Association of
Reproductive
Health
Professionals

Ever wish you had access to the *best work* of reproductive health experts everywhere?

CORE
Curricula Organizer for Reproductive Health Education

Your time is limited — spend it practicing reproductive health, not PowerPoint®. Before you create your next presentation, explore CORE, ARHP's interactive, open access, peer-reviewed slide library. **Start building today at:**

www.arhp.org/core



WOMEN'S HEALTH ISSUES
Official Publication of the Jacobs Institute of Women's Health

Women's Health Issues is a peer-reviewed, bimonthly, multidisciplinary journal that publishes original health services research and policy manuscripts related to women's health. As the official journal of the Jacobs Institute of Women's Health, the journal seeks to inform health services researchers, health care and public health professionals, social scientists, policymakers, and others concerned with women's health. Please visit www.whijournal.com to subscribe or submit a manuscript for consideration.

Free Special Supplement Issue Available Online: With support from Childbirth Connection, *WHI* published a special Jan/Feb 2010 supplement on the topic of *Transforming Maternity Care*. This issue features articles on topics such as:

- 2020 Vision for a High-Quality, High-Value Maternity Care System
- Blueprint for Action: Steps Toward a High-Quality, High-Value Maternity Care System
- Proceedings from Childbirth Connection's 90th Anniversary Symposium held on April 3, 2009 in Washington, DC
- The Role of Medicaid in Promoting Access to High-Quality, High-Value Maternity Care

Visit:
www.whijournal.com/content/supplements
for free access.

Please visit us at www.jiwh.org or e-mail whieditor@gwu.edu.

SCHOOL OF PUBLIC HEALTH AND HEALTH SERVICES
JACOBS INSTITUTE OF WOMEN'S HEALTH
THE GEORGE WASHINGTON UNIVERSITY

Jacobs Institute of Women's Health
2021 K Street NW, Suite 800
Washington, DC 20006
(202) 994-4184; email: whieditor@gwu.edu
www.jiwh.org

They trust us ...



... because of you.

How are your patients choosing a birth control method?

Simplify birth control choices for your patients by directing them to ARHP's **Method Match** to:

- Sort, filter, and compare birth control options
- Watch a short video featuring each method in English or Spanish
- Download a printer-friendly fact sheet on each method



www.arhp.org/MethodMatch

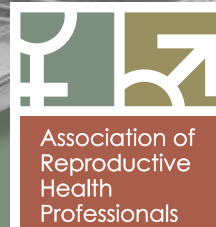

Doctors, nurses, and health professionals who work in health centers operated by Planned Parenthood® affiliates provide millions of women, men, and teens with a broad range of sexual and reproductive health services, including contraception and abortion counseling, lifesaving screenings for cervical and breast cancer, testing and treatment for HIV and other sexually transmitted infections, and medically accurate sex education.

Planned Parenthood Federation of America (PPFA) salutes the dedicated men and women who provide this important care in more than 840 health centers, and it acknowledges the members of the National Medical Committee for all they do to advance women's health and to support PPFA.

PLANNED PARENTHOOD
FEDERATION OF AMERICA

plannedparenthood.org

Calling ALL Abstracts

sex::tech[®]
presented by isis
ISIS-INC.ORG

DO YOU WORK WITH YOUTH WHO USE SOCIAL MEDIA, TEXT MESSAGING AND THE INTERNET? Abstract submission for Sex::Tech 2011 in San Francisco is OPEN. Want to learn? Register early and save.

sextech.org

sponsored by **NIMH**
NATIONAL INSTITUTE OF MENTAL HEALTH



Felicia H. Stewart MD
Stewart Center East & West
Community Space for Reproductive Health and Justice

Honor a legend by investing in the future of reproductive health and justice

Help ARHP & ANSIRH provide free, cutting-edge community meeting space for reproductive health and rights work by contributing to the Felicia Stewart Center. Through your generosity, Dr. Stewart's legacy will live on in community activism, quality research, provider education, and reproductive justice.

Please help us honor Dr. Stewart's vision by giving generously at:

www.arhp.org/FeliciaStewartCenter



Be a Performance Improvement (PI) Pioneer with ARHP

Women's health and primary care providers are often the first to encounter patients with the chronic and diffuse symptoms indicative of fibromyalgia. This practice-based initiative offers providers a structured program to identify, implement, and evaluate improvements in practice that will positively impact the quality of life of patients with fibromyalgia.

Participate in ARHP's comprehensive, online PI initiative on fibromyalgia to:

1. Earn up to **20 hours of CE credit**
2. Create **sustained improvement in patient care** in your practice
3. Improve **quality of life** for your patients with fibromyalgia
4. Access **evidence-based training** on diagnosing and treating fibromyalgia
5. **Win a snazzy new iPad**



www.arhp.org/PI

Program enrollment begins October 1, 2010. Contact Camille Harris at charris@arhp.org or (202) 621-1436 for more information or to sign up.

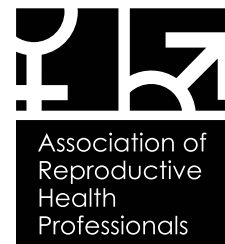

gynpages.com
1995-2010
15th Anniversary

ABORTION
CLINICS
ON-LINE

The world's first and largest source for
online abortion clinic information since 1995.

List your clinic
for only \$133/month
and get new patients
and higher page ranking

See Your Clinic Listed HERE:
www.abortionsite.com
www.abortionsitepages.com
www.birthcontrolpages.com
www.clinicasdeaborto.com

Call Today 800-455-8130

embryo
a family
building
donation
option

COMING FALL 2010—
EMBRYO DONATION PROGRAMS FOR
MEDICAL PROFESSIONALS

RESOLVE has the information
your clients need --
visit RESOLVE.org/EmbryoDonation
for

For 35 years
RESOLVE: The National
Infertility Association has
been providing those with
infertility unbiased information
and compassionate support.

- Brochures
- Free Webinars
- Support Groups
- Personal Stories
- Fact Sheets
- FAQs

 resolve
THE NATIONAL INFERTILITY ASSOCIATION

This content made possible by grant number EAAPA071012-00-00 from the U.S. Department of Health and Human Services. The content is solely the responsibility of RESOLVE and does not necessarily represent the official views of HHS.

Improving Women's Health Through Disease Detection

LabCorp is committed to providing accurate, timely results to assist in diagnosis, treatment, and management of health conditions. With an integrated network of regional laboratories and premier esoteric testing facilities, LabCorp offers a comprehensive menu of specialized and routine tests that address the health concerns of women through all life's ages, phases, and stages. Please visit the LabCorp booth to learn more about our services and comprehensive Test Menu.



 LabCorp
Laboratory Corporation of America

©2010 Laboratory Corporation of America® Holdings All rights reserved. 8524-0710



Cultivating a collaborative and supportive environment to foster scholarly activity and leadership in the areas of reproductive health and family planning.

Join us!

Help shape the Society and help shape the field. Benefit from SFP research grants, opportunities to network with like-minded colleagues and to be exposed to the latest in family planning research, a subscription to *Contraception*, and the chance to participate in Society committees.

“Our SFP grant enabled us to transition an idea and some preliminary data into a much more significant research project. What’s more, SFP’s rapid review and response process will make our data available to other researchers in the field at least a year earlier than it would have been if funded by other grant mechanisms.”

—David Turok, MD

SFP Membership is open to any qualified individual in good professional standing who has an interest in family planning demonstrated through post-doctoral training, a substantial clinical or laboratory practice, or academic presentations and publications within this field.

To learn more and apply online: www.societyfp.org



Committed to Women’s Health

Teva’s Women’s Health group produces a wide range of women’s healthcare products including oral contraceptives, intrauterine contraception, hormone therapy treatments for menopause/perimenopause and continues to invest in research and development to satisfy needs in Women’s Health. All of Teva Women’s Health products are produced under the Duramed Pharmaceuticals, Inc. label in the U.S. and Canada.

Her Life... Our Passion



TEVA WOMEN’S HEALTH



on *your* schedule,
worth *your* time



The timely, scientific, evidence-based educational content you expect from ARHP, delivered to your desktop.

Archived Sessions	Faculty
A Clinical Update on Intrauterine Contraception	David Grimes, MD
Breaking the Contraceptive Barrier: Techniques for Effective Contraceptive Consultations	Linda Prine, MD
Environmental Impacts on Reproductive Health: Foundations of Science	Ted Schettler, MD, MPH
Environmental Impacts on Reproductive Health: Pesticides	Tracey Woodruff, PhD, MPH
Explaining Contraceptive Risk to Patients	David Grimes, MD
Facing Facts About the Effectiveness of ECPs	James Trussell, PhD, BPhil
Managing HPV: A New Era in Patient Care	Anafidelia Tavares, MD, MPH
Options for Early Pregnancy Loss: MVA and Medication Management	Emily Godfrey, MD, MPH
Screening, Treatment, and Management of Interstitial Cystitis/Painful Bladder Syndrome	Lee Shulman, MD

Good science, easy access, and convenient continuing education credit – live and archived sessions are always **FREE** at www.arhp.org/webcme.

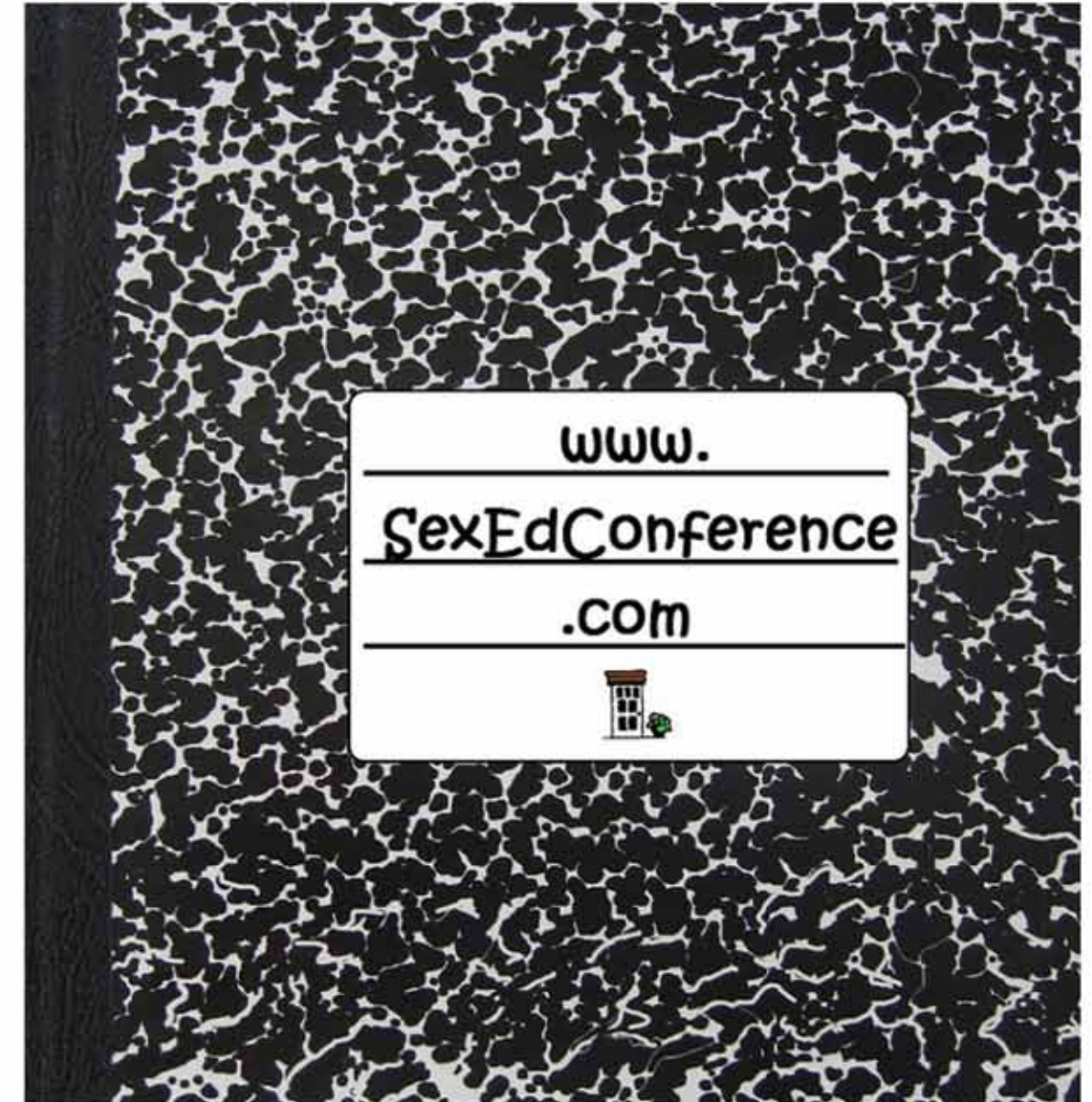

Don't miss the Sex Ed Conference of the Year!

And be sure to stock your Sex Ed library by visiting www.SexEdStore.com



www.arhp.org



Reproductive Health

Education • Research • Advocacy

Reproductive Health 2011 will combine the best traditions from our 47 year history with innovative training strategies to create the reproductive health professional's ideal clinical conference.

Save the Date
September 15-17, 2011
www.ReproductiveHealth2011.org

**ARHP's new & improved
Reproductive Health meeting
will feature:**

- **Innovative learning platforms** and expanded workshop opportunities for hands-on skill building
- **The latest research, guidelines, and clinical trends** to help inform your work
- **Practical provider education** for translating the latest research into daily practice
- **Networking opportunities** to connect with committed, pro-choice colleagues across disciplines and specialties
- **Virtual conference webinars** on late-breaking research and hot topics in reproductive health